

Installation Guide

Varisys Wireless Payment Acceptance System
<UPP-WPAT-1208>

Table of Contents

Operation Instruction Varysis Wireless Payment acceptance System

Preliminary Note	3
Firmware version check for UP-CR20L	4
Connecting to the Network(1 to 1 connection)	5-8
Connecting to the Network(Multiple connection)	9
Connecting to the Network(Multiple connection)Additional terminal set up ...	10-12
Connecting to the Network(Multiple connection)Additional dongle set up	13-16
How to set up the dongle for UP-CR20L	17
Checking UP-CR20L Firmware version.....	18
Configuring UP-CR20L's Administration Settings.....	19
Operation check for Configuration	20
Operation guide	21
Modification History	22

Preliminary note

- Connecting Distance Ability
 - Terminal ↔ Dongle About 35m(Direct distance)
 - Terminal ↔ Terminal About 25m(Direct distance)
- The radio wave might be un-connected or the connection will be shut off , if there are Metallic wall or partition around.
- Zigbee(2.4GHz) is applied for Wireless Specification. There are possibility of interfering with the Wireless LAN (IEEE 802.11b/g/n) or the Bluetooth.
- Therefore, we recommend to confirm the connectivity and stability at the real usage environment beforehand.
- Also ,we recommend to prepare the preliminary terminal when you set up, as it might perform the relay function, and improve the circumstances.

Firmware version for UP-CR20L

- The firmware version in the Snap Lab UP-CR20L has to be v1.60 or greater. Since you may not be able to access network at installation venue, we strongly recommend to download latest firmware upgrade module from following URL and copy the firmware into memory card in advance.

Snap Lab Support Page

<http://www.sony.net/snaplab>

- For more details for procedure, please refer “Notes and procedure for firmware upgrade module download” in the page.

Connecting to the Network(1 to 1 connection)

Please follow the following steps to set up the 1 to 1 connection of Terminal and the dongle.

***Note1**

There is a possibility of failure set-up if you connect the dongle and the AC adaptor first, and connect the terminal and the dongle secondly.

① Connect the terminal and the dongle.

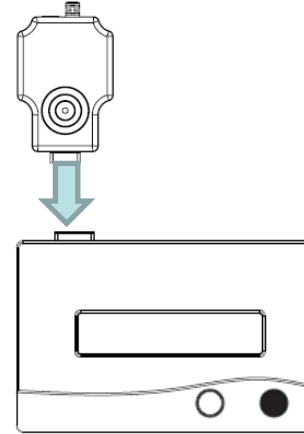

***Note1**

② Connect the dongle and the AC adaptor.

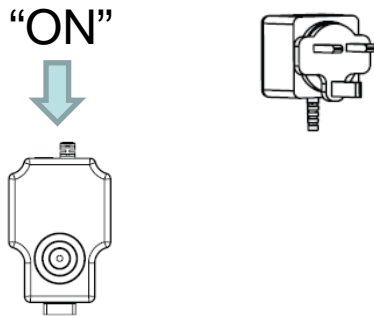

③ Hold down the black button, and connect the terminal and the AC adaptor.

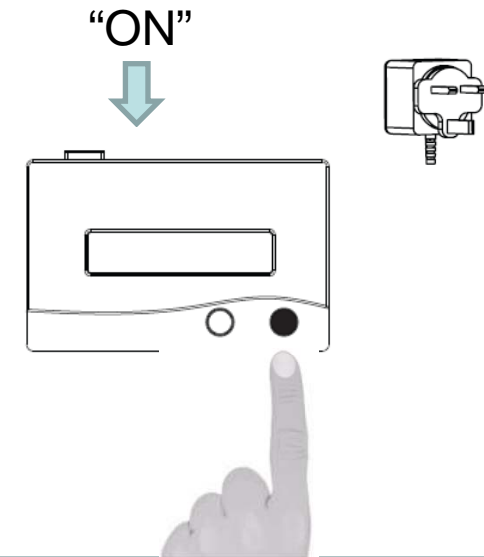

Connecting to the Network(1 to 1 connection)

④ Press the Black button.

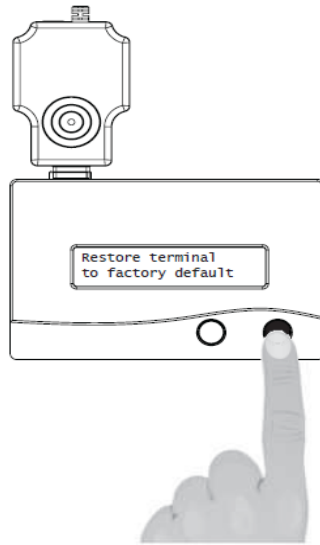

⑤ Press the Green button.

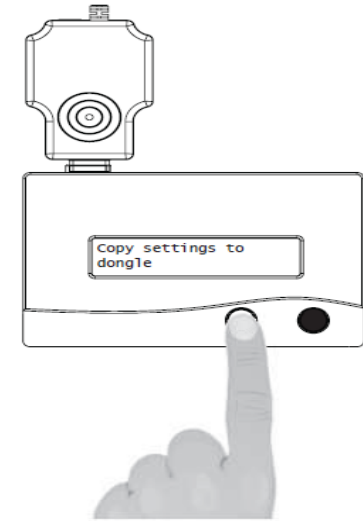

⑥ Press the Green button.

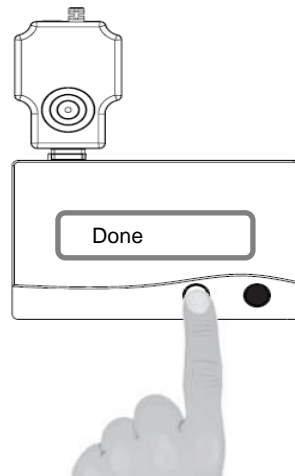

⑦ Press the Black button 3 times

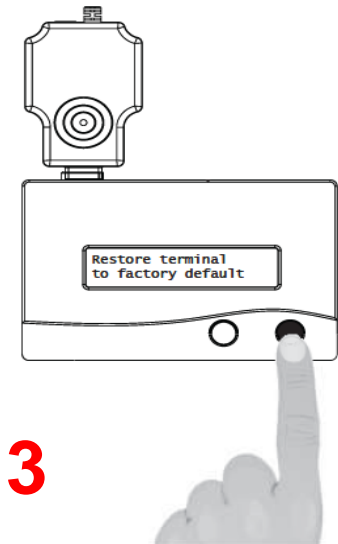

× 3

Connecting to the Network(1 to 1 connection)

⑧ Press the **Green** button.

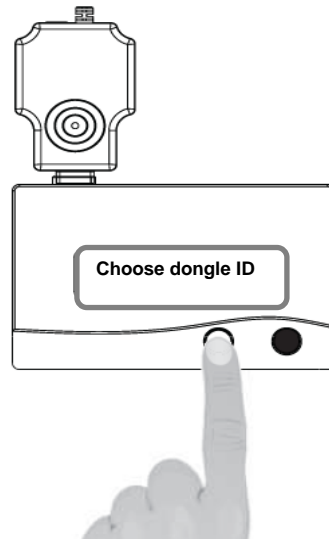

⑨ Press the **Green** button.

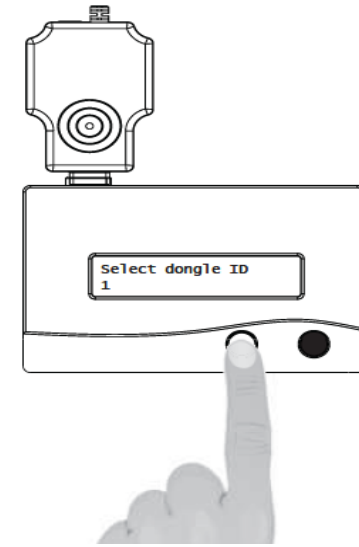

⑩ Press the **Green** button

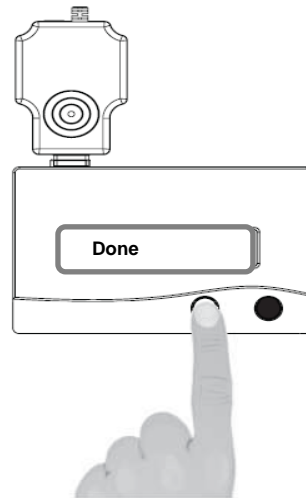

⑪ Check the display indicating "Restore terminal to factory default"

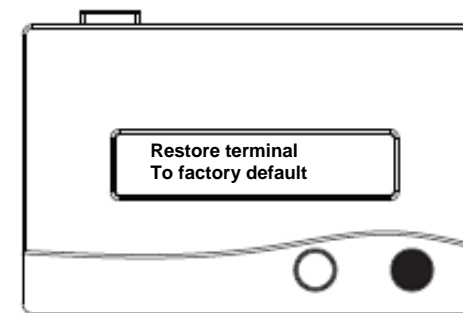

Connecting to the Network(1 to 1 connection)

⑫ Take off the AC adaptor for both dongle and terminal.

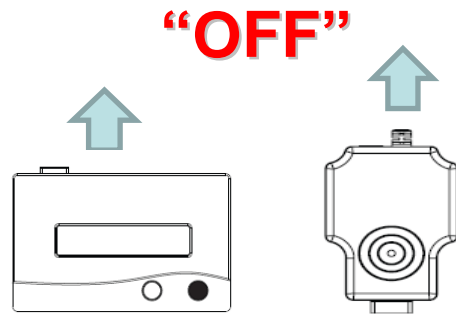

⑬ Take off the dongle from the terminal.

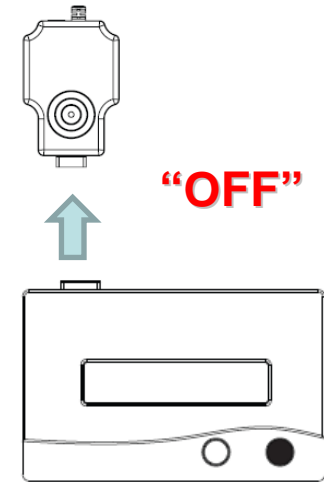

Attention : Do not connect the AC adaptor and the USB to the dongle at the same time, as it might break!!

Connecting to the Network (Multiple connection)

Please follow the following steps to set up the multiple connection of Terminal and the dongle.

1. Please follow the manual “Connecting to the Network(1 to 1 connection)” pg 5~8 and set up a pare ring.
2. Please follow the following steps(pg 10~12) to set up the additional terminal.
3. Please follow the following steps (pg 13~16)to set up the additional dongle.

Connecting to the Network (Multiple connection)

Additional terminal set up

Please follow the following steps to set up the additional terminal.

* Note2

Do not connect the terminal and the dongle after connecting the AC adaptor, as there is a possibility of failure set up.

① Connect the dongle, the one which you configured in the previous step, and the terminal which you want to set up

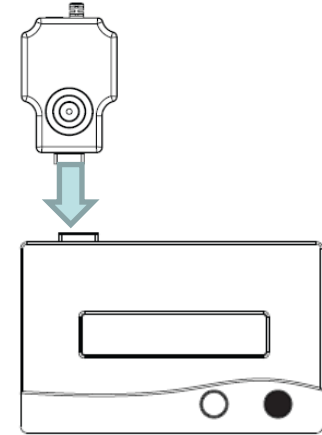

* Note2

② Connect the dongle and the AC adaptor.

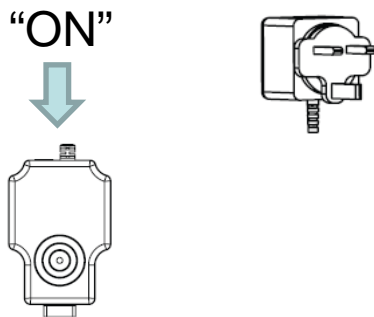

③ Hold down the black button, and connect the terminal and the AC adaptor.

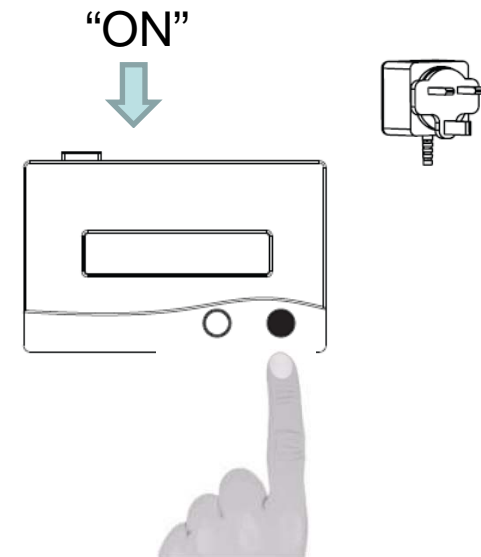

Connecting to the Network (Multiple connection)

Additional terminal set up

④ Press the Black button 2 times.

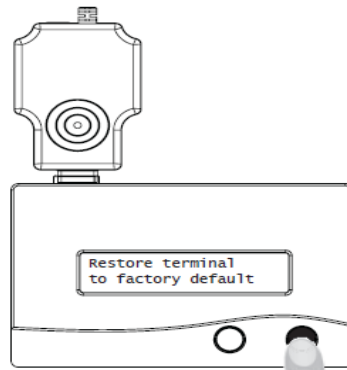

× 2

⑤ Press the Green button.

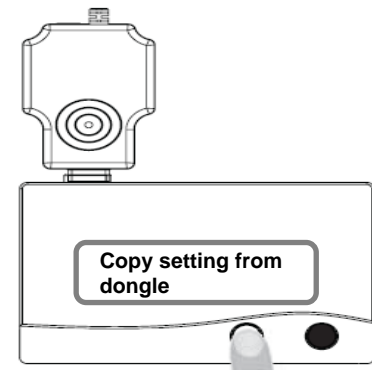

⑥ Press the Green button.

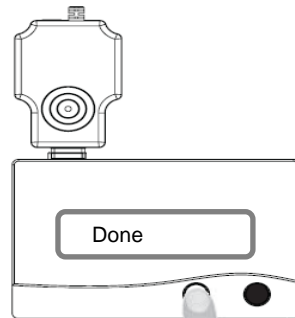

⑦ Check the display indicating "Restore terminal to factory default"

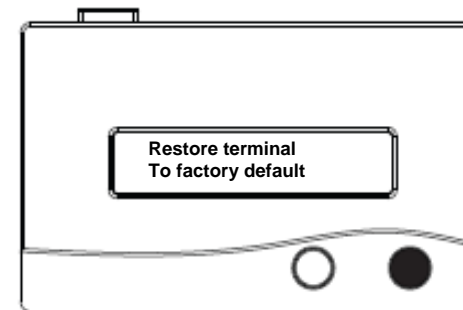

Connecting to the Network (Multiple connection)

Additional terminal set up

⑧ Take off the AC adaptor for both dongle and terminal.

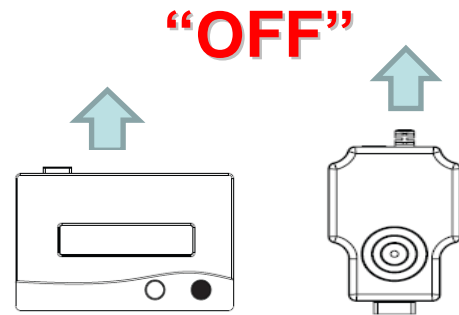

⑨ Take off the dongle from the terminal.

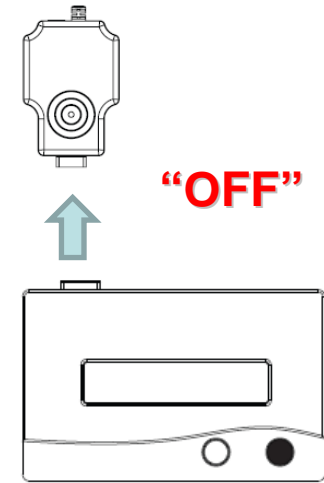

Attention: Do not connect the AC adaptor and the USB to the dongle at the same time, as it might break!!

Connecting to the Network (Multiple connection)

Additional dongle set up

Please follow the following steps to set up the additional dongle.

* Note3

Do not connect the terminal and the dongle after connecting the AC adaptor, as there is a possibility of failure set up.

① Connect the terminal, the one which you configured in the previous step, and the dongle which you want to set up

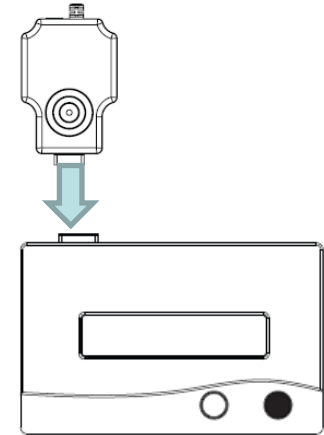

* Note3

② Connect the dongle and the AC adaptor.

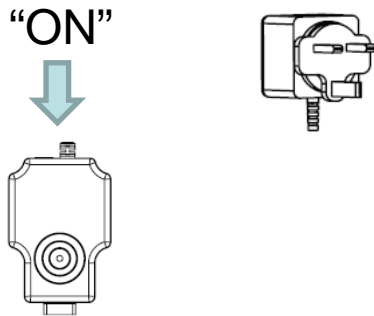

③ Hold down the black button, and connect the terminal and the AC adaptor.

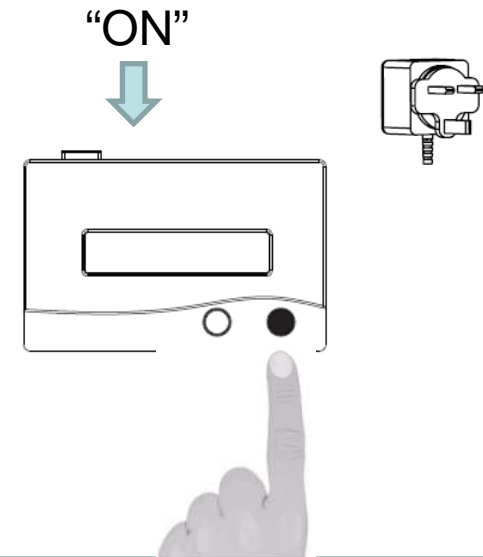

Connecting to the Network (Multiple connection)

Additional dongle set up

④ Press the Black button.

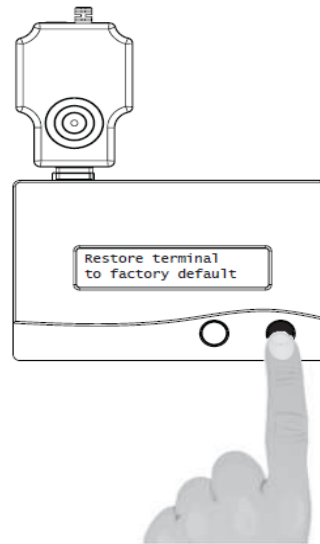

⑤ Press the Green button.

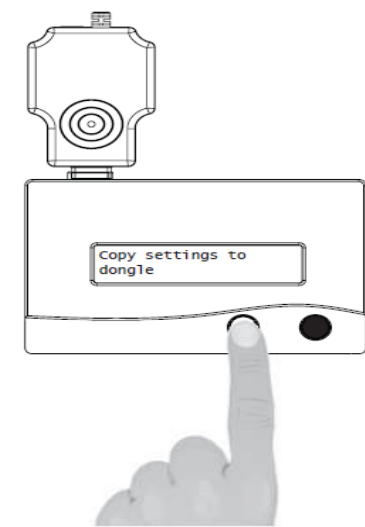

⑥ Press the Green button.

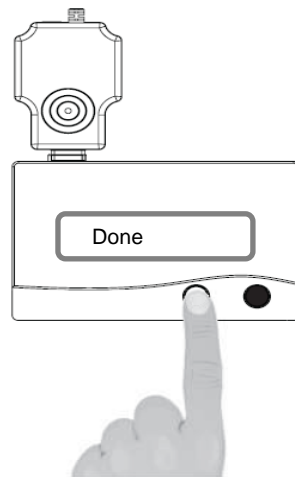

⑦ Press the Black button 3 times

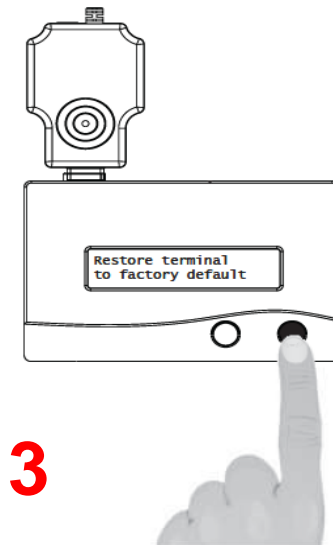

× 3

Connecting to the Network (Multiple connection)

Additional dongle set up

⑧ Press the **Green** button.

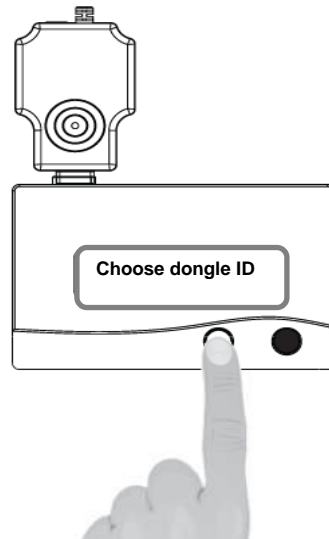

⑨ Press the Black button, and display ID # which you want to setup

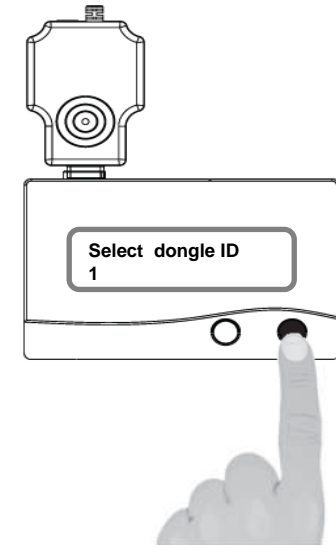

***Note 4**
Do not set up the same ID #.

⑩ Press the **Green** button.

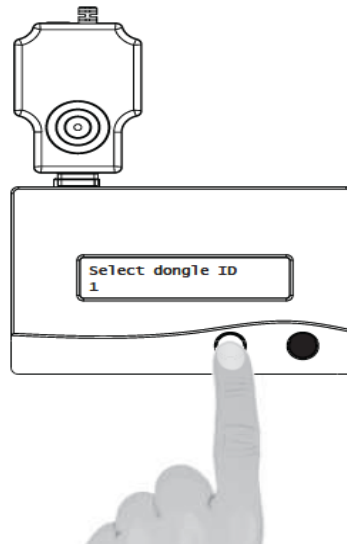

⑪ Press the **Green** button

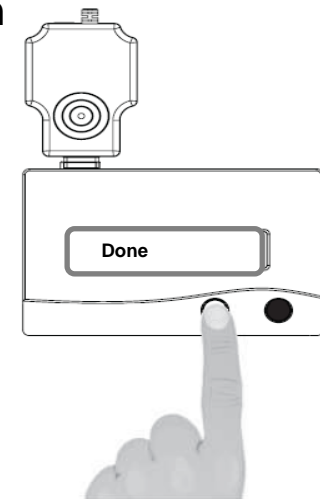

Connecting to the Network (Multiple connection)

Additional dongle set up

⑫ Check the display indicating
“Restore terminal to factory default”

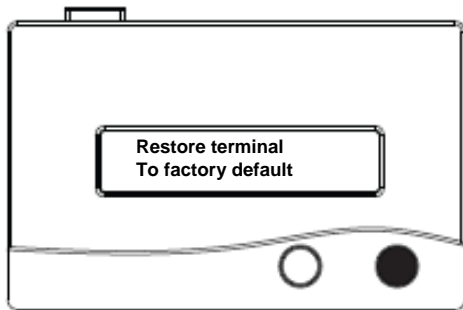

⑬ Take off the AC adaptor for both
dongle and terminal.

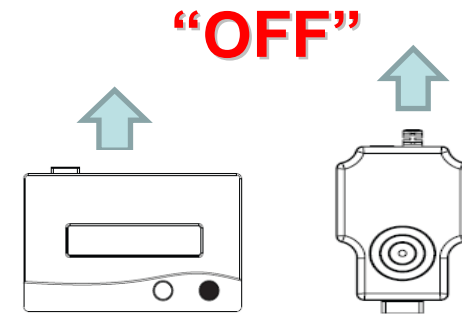

⑭ Take off the
dongle from the
terminal.

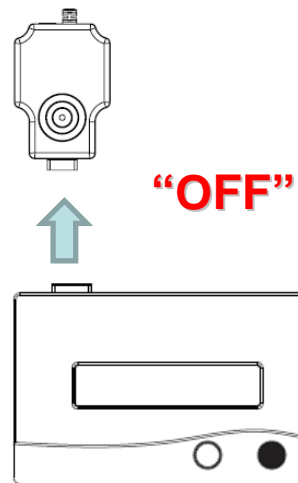

**Attention: Do not connect the AC adaptor
and the USB to the dongle at the same
time, as it might break!!**

How to set up the dongle for UP-CR20L

Please follow the following steps to set up the dongle to UP-CR20L.

1. Power off the UP-CR20L.
2. Open the Extension connector cover.
3. Insert the included CF card to Expansion CompactFlash card Slot.
4. Connect the dongle to the RS-232C connector.
5. Connect the USB connector to the USB port(host)<Either one will be fine>
6. Close the Extension connector cover.

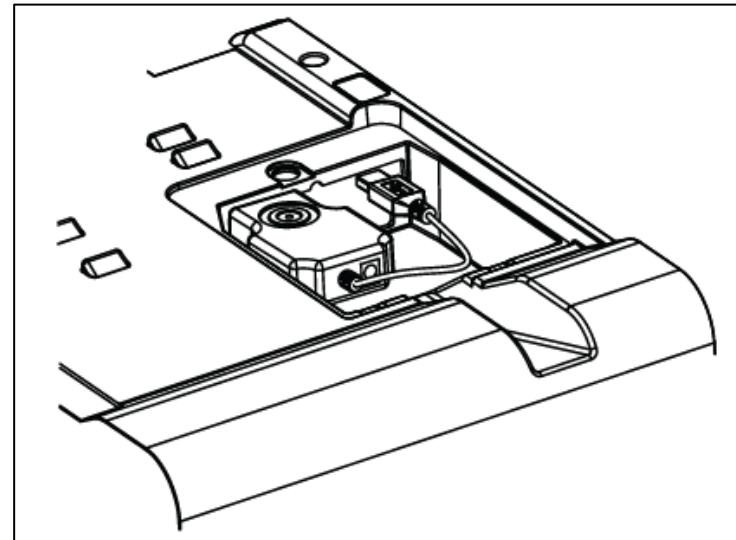
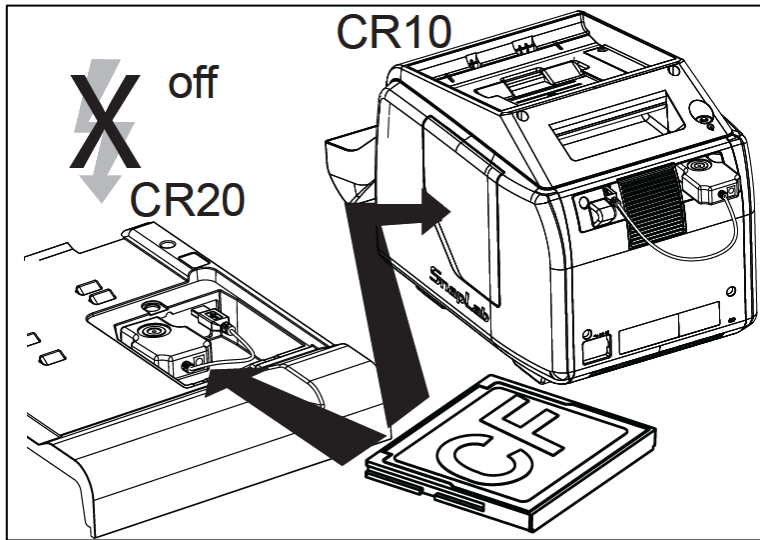

Attention: Do not connect the AC adaptor and the USB to the dongle at the same time, as it might break!!

Checking UP-CR20L Firmware Version

To use Varisys WPAT, the firmware version on Snap Lab has to be V1.60 or greater in the case you use UP-CR20L.

The firmware version can be found in the system log under the administration tab in the UP-CR20L administration menu.

1. Turn on the UP-CR20L power.
2. Touch the top left corner of the “Touch screen to start” screen twice and then enter the administration password.
3. Touch Administration tab then touch System Logs button.
4. The firmware version is displayed at the bottom. If version is younger than V1.60, please upgrade UP-CR20L Firmware.



Attention: Do not turn off the power while firmware is being upgraded. It would take about 5 minutes. The printer will be restarted automatically after upgrade.

Configuring UP-CR20L's Administration Settings

Snap Lab administration settings Mode Selection, Price Indication, Pricing and Password have to be configured accordingly before use.

(Please refer UP-CR20L Operating Instructions Chapter 3, 4)

To get into administration settings, touch the top left corner of the screen twice then enter the administration password.

1. Selecting the Operation Mode (P.33) under System tab
Select [Full Mode] or [Quick Print Mode] for [Mode Selection]

2. Setting Image Preload (P.47) under System tab
Select [ON] for [Load images before printing]

3. Setting the Passwords (P.36) under Administration tab
Select [ON] for [Password]

4. Setting Prices (P.34) under Pricing tab
Select [ON] for [Price Indication]
Set the prices for prints



Operation check for Configuration

1. Turn on the UP-CR20L power.
2. Turn on the terminal power.
3. Confirm the terminal is indicating "Choose Printer", and the ID number which was configured in the previous process is indicating too.
4. Select the picture to be printed out, and touch the "Print Start" button on the right bottom corner of the LCD display(UP-CR20L).
5. Confirm the ID # is blinking on the terminal.
6. Select the ID # by pressing the black button on the terminal
7. Press the **Green** button, and check the terminal is indicating the charged amount .
8. Press the **Green** button(1 ~2seconds),and check the terminal is indicating "Printing".
9. Confirm the UP-CR20L has printed out the media as usual.
10. To confirm the connection stability , please check the terminal is consistently indicating the terminal ID # for about 5 minutes.
If the connection is lack of stability , please change the location or add the terminal and try it again.

Operation guide

Power Activation

1. Turn on the UP-CR20L power.
2. Turn on the terminal power.
3. LCD display of the terminal will indicate "Connecting"
4. Few seconds later, the LCD display will indicate "Choose Printer", and the ID number which was configured in the previous process will be indicating too.

Operation Instruction

1. Select the picture to be printed out, and touch the "Print Start" button on the right bottom corner of the LCD display(UP-CR20L).
2. ID # will be blinking slowly on the terminal display.
3. Select the ID # by pressing the black button on the terminal
4. Press the Green button, and the terminal will indicate the charged amount.
5. <To print out>
 - Press the **Green** button(1~2seconds)
 - Terminal display will indicate "Printing", and starts printing.
 - Terminal display will indicate "Printed" when it finishes the printing.
 - Within about 5 seconds after printing, the Terminal display will indicate "Choose printer".
6. <To cancel the printing >
 - Press the Black button on the terminal for 2~3 seconds.
 - Terminal display will indicate "Cancelled" and the job will be cancelled
 - Within about 5 seconds, the terminal display will indicate "Choose printer"
7. <Error Display> The ID # on the terminal display will blink fast if there are error on the printer
 - A) Press the Black button and select the ID # which you desire to operate.
 - B) If you press the **Green** button, the display will indicate the detail of the error matter.
 - C) If you resolve the problem, the terminal display will indicate "Printer idle", within about 5 seconds, the display will change to "Choose printer".

Modification history

- First version

July 8th ,2009