

D703		
Film types*1	LS-600/1100, HS-1800	Color negative and positive, B&W negative
Film formats*1	LS-600 / 1100	135F, 135H, 135P, 135FP, 135FPS, IX240
	HS-1800	110, 135F, 135H, 135P, 135FP, 135FPS, IX240, 6x4.5, 6x6, 6x7, 6x8, 6x9
Compatible input media*2+3	Standard	HDD, CD-ROM, CD-R, CD-RW, DVD-ROM, DVD-R, DVD+R, DVD-RW, DVD+RW, DVD-RAM
	Option	Microdrive, CompactFlash, SmartMedia, SD Card, MMC, RS-MMC, Mini SD Card, Memory Stick, Memory Stick Pro, Memory Stick Duo, Memory Stick Pro Duo, xD-Picture Card, USB Flash Memory
Compatible output media*2+3	Standard	HDD, CD-R, CD-RW, DVD-RAM
	Option	DVD-R, Microdrive, CompactFlash, SmartMedia, SD Card, MMC, RS-MMC, Mini SD Card, Memory Stick, Memory Stick Pro, Memory Stick Duo, Memory Stick Pro Duo, xD-Picture Card, USB Flash Memory
Printing system	Inkjet system	
Print resolution	720x720dpi	
Film scanning method*1 (LS-600/1100, HS-1800)	Main scanning: Independent line exposure via 3 line CCD Sub scanning: Film movement	
Print Sizes	<b>Roll paper:</b> Width: 102, 127, 152, 203, 254mm Advance length: When the width is 102, 127, 152mm: 89 to 457mm When the width is 203, 254mm: 89 to 914mm (An option is required when making prints with an advance length that exceeds 457mm) <b>Sheet paper:</b> Width: 127 to 216mm Advance length: 200 to 297mm Max. no. of sheets: Up to 20 can be set in tray	
Maximum print size	254 x 914mm* (Roll paper) / 216 x 297mm (sheet paper) *The maximum advance length when not using a RIP-PC is 610mm (24")	
Paper specifications	<b>Roll paper:</b> Noritsu inkjet photo paper (semi-glossy/glossy) Paper thickness: 242µm Length of paper roll: 100m <b>Sheet paper:</b> Noritsu recommended paper	
Ink	4 colors of dye ink: Y (Yellow), M (Magenta), C (Cyan), BK (Black) Volume: 500ml per color	
Dimensions	See "External view" below	
Weight	Scanner*1 (LS-600/LS-1100/HS-1800)	LS-600: Approx. 16.7kg / LS-1100: Approx. 17.5kg / HS-1800: Approx. 18.6kg
	D703	Approx. 96.0kg (Not including RIP-PC)
Power specifications	AC100-120V / 200-240V 1P2W (Not including RIP-PC)	
Rated power capacity	800VA or less (Not including RIP-PC)	

\*1 The film scanner (LS-600/LS-1100/HS-1800) is sold separately.  
 \*2 Going through the EZ Controller (sold separately).  
 \*3 Capacities may vary depending on the PC, card reader used.  
 Capacities shown above represent values when using the computer system supplied by Noritsu Koki.

RIP-PC	
CPU	Celeron D 3.2 GHz
OS	Windows XP Professional SP2 English version
Memory	512MB
Hard disk	40GB
Media drives	CD-R drive
External interface	Ethernet (1000 base): 1 port USB 2.0: 3 ports PS/2: 1 port Video (VGA): 1 port Serial (COM): 1 port Parallel (EPP/ECP support): 1 port

Repeat Printing Capacity (prints/hr)		
Print size (Width x Paper advance length)	Paper	Capacity (Approx.)
127 x 89mm (5" x 3.5")	Roll	750
102 x 152mm (4" x 6")		510
152 x 102mm (6" x 4")		650
203 x 254mm (8" x 10")		250
254 x 203mm (10" x 8")		280
254 x 305mm (10" x 12")		195
203 x 264mm*5	Sheet	35
210 x 307mm*5		33

135F Negative Film Print Capacity (prints/hr) *1			
Print size (Width x Paper advance length)	Paper	Capacity (Approx.)	
		LS-600	HS-1800
127 x 89mm (5" x 3.5")	Roll	600	750
102 x 152mm (4" x 6")		510	510
152 x 102mm (6" x 4")		600	650
203 x 254mm (8" x 10")		250	
254 x 203mm (10" x 8")		280	
254 x 305mm (10" x 12")		170	160
203 x 264mm*5	Sheet	35	
210 x 307mm*5		33	

4 Megapixel Digital Camera Print Capacity (prints/hr) *2 *3		
Print size (Width x Paper advance length)	Paper	Capacity (Approx.)
127 x 89mm (5" x 3.5")	Roll	750
102 x 152mm (4" x 6")		510
152 x 102mm (6" x 4")		650
203 x 254mm (8" x 10")		250
254 x 203mm (10" x 8")		280
254 x 305mm (10" x 12")		195
203 x 264mm*5	Sheet	35
210 x 307mm*5		33

6 Megapixel Digital Camera Print Capacity (prints/hr) *2 *4		
Print size (Width x Paper advance length)	Paper	Capacity (Approx.)
127 x 89mm (5" x 3.5")	Roll	750
102 x 152mm (4" x 6")		510
152 x 102mm (6" x 4")		650
203 x 254mm (8" x 10")		250
254 x 203mm (10" x 8")		280
254 x 305mm (10" x 12")		195
203 x 264mm*5	Sheet	35
210 x 307mm*5		33

\*1 When used with the separately sold EZ Controller and film scanner.  
 \*2 When used with the separately sold EZ Controller.  
 \*3 512MB xD-Picture Card. 2304 x 1728 pixels per image.  
 \*4 512MB xD-Picture Card. 3024 x 2016 pixels per image.  
 Calculated according to our criteria. The actual capacity you achieve may be different.  
 \*5 When making 203 x 254 mm and A4 size (210 x 297 mm) prints, you need to cut 5 mm off the rear edge of the print after it is printed. (The front edge of the print is cut off automatically (5mm).)

# NORITSU

A high performance dry printer for progressive retailers

# D703



External view (Unit: mm)

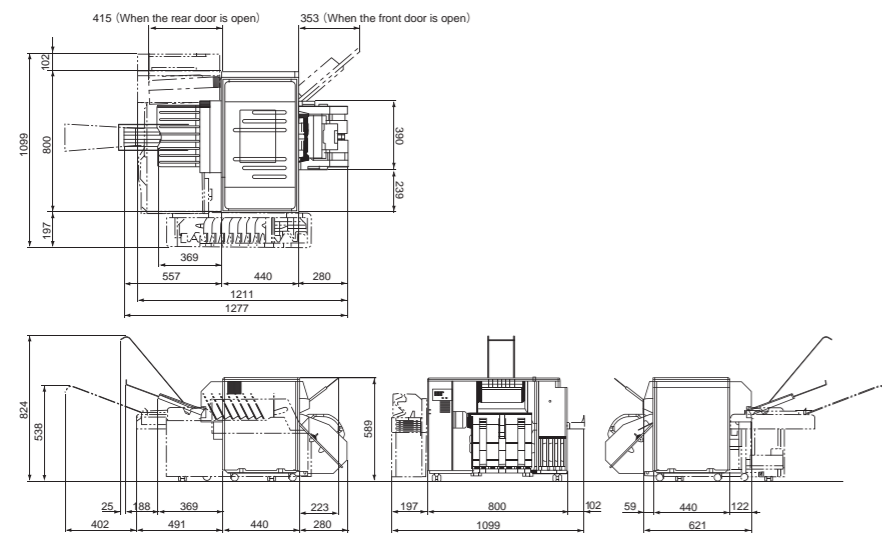

Space required for installation (Unit: mm)

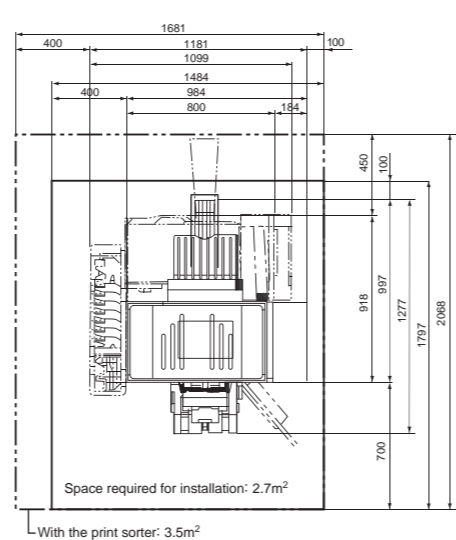

**NORITSU KOKI CO., LTD.**

579-1 UMEHARA, WAKAYAMA-SHI, 640-8550, JAPAN  
 PHONE:(81)73-454-0345 FACSIMILE:(81)73-454-0301  
 http://www.noritsu.co.jp

**COUNTRY OFFICE**  
 Australia Noritsu Koki Australia Pty. Ltd.  
 Brazil Noritsu Do Brasil Ltda.  
 Canada Noritsu Canada Ltd.  
 The Czech Rep. Noritsu (CR) spol. sr. o.  
 China Noritsu (Shanghai) P. E. M. Co., Ltd.  
 France Noritsu France E. U. R. L.  
 Greece Noritsu Hellas Ltd.  
 Germany Noritsu (Deutschland) GmbH  
 Hong Kong Noritsu (Far East) Ltd.  
 India Noritsu India Branch  
 Italy Noritsu Italia S. r. l.

**PHONE NO.**  
 (61) 2-9317-2141  
 (55) 92-3615-4300  
 (1) 905-567-8982  
 (420) 241-040901  
 (86) 21-5046-3997  
 (33) 1-57-02-12-90  
 (30) 210-6019506  
 (49) 2154-9157-0  
 (852) 2873-4788  
 (91) 11-41427245  
 (39) 0321-445211

**COUNTRY OFFICE**  
 Malaysia Noritsu Koki Malaysia Sdn. Bhd.  
 Mexico Noritsu Mexico S.A. De C.V.  
 The Philippines Noritsu Philippines, Inc.  
 Poland Noritsu (Poland) Sp. z.o.o.  
 South Korea Noritsu Seoul Branch  
 Russia Noritsu (R) Ltd.  
 Singapore Noritsu Singapore Pte. Ltd.  
 Taiwan Noritsu Taiwan Co., Ltd.  
 U. A. E. Noritsu Near East Branch  
 U. K. Noritsu (UK) Limited  
 U. S. A. Noritsu America Corporation

**PHONE NO.**  
 (60) 3-78762733  
 (52) 55-2626-6710  
 (63) 2-812-8443  
 (48) 22-863-2800  
 (82) 2-569-2701  
 (7) 495-933-6446  
 (65) 6778-8333  
 (886) 2-2508-1908  
 (971) 4-8837556  
 (44) 1908-371100  
 (1) 714-521-9040

NORITSU is a trademark of Noritsu Koki Co., Ltd.  
 All other product and company names herein may be trademarks of their respective owners.

Our products have been manufactured under an ISO 9001-certified quality assurance system.

Printed on recycled paper. 2009.02 TAC 101



Discover the possibilities of dry technology



The ideal dry printer solution for retailers.  
The D703 unlocks the key to progressive possibilities  
in the photo retail business.

# A progressive printer that leads the way



With all the digital cameras and cameraphones in people's hands throughout the world today, photography has become very commonplace. This is an encouraging trend, but the photography process should not end at the image capture stage. Ideally, image output should be just as commonplace as image capture, and we believe the D703 is just the right printer to trigger an increase in consumer printing. This dry printer makes it easy for retailers to provide exciting print services, and it provides endless possibilities for meeting the needs of progressive photo retailers and the customers they serve.

**For progressive shops**



- Space-saving design. Opens up more space for value-added products and other retail needs, etc.
- Minimal investment required to start up a new business.
- A household power supply and a PC are all you need to provide a high-grade print service.

**For progressive customers**



- High quality prints produced with newly developed ink.
- An array of value-added photo products that create excitement and motivate customers to print.
- The excellent image permanence ensures your customers' precious photos will withstand the test of time.

**For progressive workflows**



- Dry system. No photofinishing chemical maintenance.
- Numerous options to improve workflow efficiency.
- Environmentally-friendly. Safe and clean.

**For progressive network systems**



- Smooth operation with the EZ Controller.
- Easy image correction and order management.
- Scalable system configuration to meet individual needs.



For progressive shops

# This ultra compact design will open the door to a new realm of possibilities.

The reduction in installation space is one of the attractive features of dry printers. The small footprint helps to free up space, which can be used for creative purposes such as providing new services.

## A footprint of just 0.35m<sup>2</sup>. Can freely change the layout according to your needs.

The D703's small body helps you use your floor space effectively. The space saved provides a larger area for your customers to roam around, and it makes more space available for showing your customers the value-added products you offer.

More space to talk with your customers

More space to display value-added products

Its compact size makes it an ideal solution for studios and coffee shops.

## Low initial investment. Low running costs.

The D703 requires a substantially lower initial investment than silver halide printers, and this makes it a wise purchase for those who are opening a new shop. No photofinishing chemicals are used, which eliminates the need to wait around for chemicals to warm up to their proper temperature. With the D703, you can print the images you need, in the exact quantity you need, when you need them. This reduces waste and helps to keep the total costs down.



Footprint Approx.

# 0.35m<sup>2</sup>

## Small but powerful. Can connect multiple printers for an increase in capacity.

When using roll paper, the D703 can produce up to 650 prints per hour. If you need a higher capacity, you can always install multiple printers. Their small size and the stacking feature make it possible to produce large volumes in a minimal amount of space.

Roll paper (4R: 152 x 102mm)

Approx. **650** prints / hr

When double stacking

Approx. **1,300** prints / hr

Sheet paper (210 x 307mm)

Approx. **33** prints / hr

Double Stack Cabinet OPTION



Calculated using digital camera media (6 megapixels) and the EZ Controller (High-spec. PC). Calculated according to our criteria. The actual capacity you achieve may be different. When printing the A4 size (210 x 297mm), you need to cut 5mm off the rear edge of the print after it is printed. (The front edge is cut off automatically (5mm).)

## All you need is a computer and a household power supply. This makes it easy to install just about anywhere.

This printer does not have any special electrical requirements and does not require the use of a RIP\* -PC. These two things make it easy for anyone to install right away, and the printer's short time for first-print output give you an instant competitive edge.



### Time to first print

152 x 102mm (6" x 4") >>>>> Approx. **49** seconds

254 x 203mm (10" x 8") >>>>> Approx. **62** seconds

\*RIP: Raster Image Processor



For progressive customers

# A printer that turns your memories into treasures.

The D703 gives your precious images a tangible form by turning them into beautiful prints.

## Beautiful sharp prints with the 6-gradation-per-dot ink system.

The D703 uses a newly developed dye ink system that accurately portrays fine details due to its excellent gradation range of 6 gradations per dot. The high quality ink, combined with the excellent absorbing ability of the paper, enables the D703 to produce high quality prints that do not take a back seat to silver halide photos.

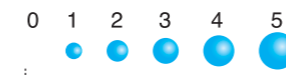
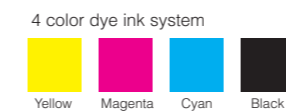

6 gradations (No dot variation + 5 dot sizes)

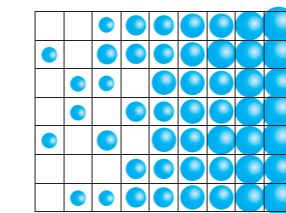

Fine gradations resulting in photos with smooth color tones

High quality prints with excellent portrayal of vivid colors and smooth gradation



## High quality prints. High grade ink that produces long lasting colors.

The new dye ink used in the D703 has an improved molecular structure so it is able to withstand light and ozone.

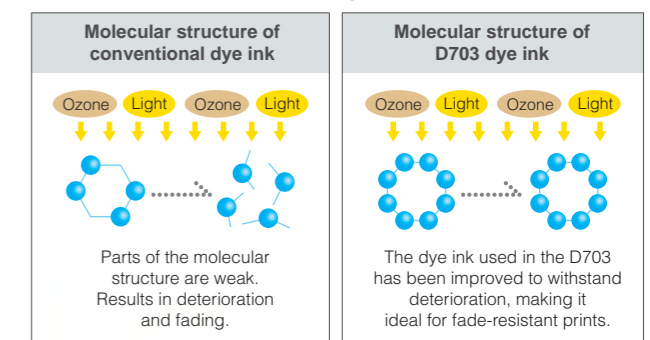

## The D703 provides many exciting ways to turn your customers' precious images into high quality photo products.

Prints are a great way to convey the fun, the many possibilities, and the essential value associated with photos. The D703 can make a wide variety of print sizes, including 254 x 914mm (10" x 36")\* and many other sizes. This printer provides the perfect solution for catering to the basic customer needs of "wanting to enjoy their photos" and "wanting to preserve their memories."

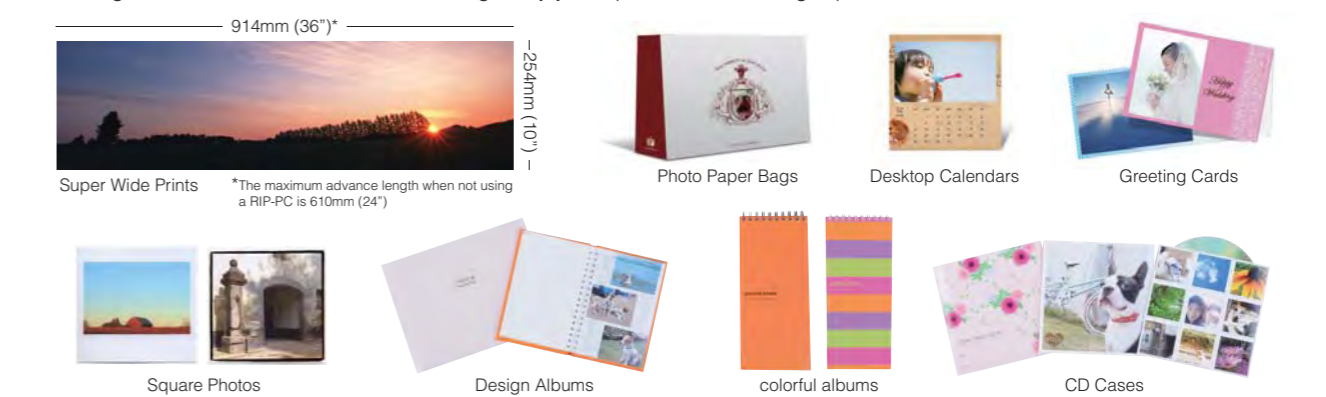

Customers can order value-added photo products on CT terminals



For a progressive workflow

## Scalable to your needs. Maintenance is easier than ever.

There is no need for chemical management with this dry system. It has an array of convenient options to make your job all that much easier.

### The print sorter unit is an indispensable asset. OPTION

A print sorter unit is available to improve operator efficiency. This eliminates hassle by automatically separating your customers' prints into orders.



Orders  
**8** orders  
Maximum no. of prints  
**50** prints / tray

A Long Print Stocker is included with the Print Sorter Unit

### A dry printer that does not use photofinishing chemicals. It is friendly to the environment, and ink replacement is a breeze.

There are no photofinishing chemicals involved with dry systems, which means you do not have to worry about maintaining specified temperatures, handling and disposing solution, or other related troublesome tasks. The only real maintenance that is required for this environmentally-friendly printer is ink cartridge replacement, which is very easy for anyone to do.



Simple ink cartridge replacement



### Can handle large-volume demands and a wide variety of print sizes. When one roll runs out of paper, it automatically switches to the other roll.

An optional magazine can be added so as to enable you to use a total of two paper rolls including the built-in roll paper loading system. This allows you to use different size rolls for print size variation. Also, if you choose to use the same size paper, the D703 will continue to print even when one roll is depleted, as it will automatically switch to the other roll.



Roll paper replacement is easy



Using two rolls enables an array of print sizes OPTION



The sheet paper tray can be folded and tucked away

It is possible to use sheet paper even when the paper magazine is attached.

### A wide variety of paper sizes. High quality paper for beautiful photos.

Many varieties of high quality paper are available for the D703. This means the finest quality paper is used in the finest quality printer, resulting in prints of the utmost quality.



A wide variety of paper types and sizes



For progressive network systems

## Easy operation with an intuitive user interface.

A flexible system configuration that can be scaled to meet your particular needs. A wide variety of software and peripheral equipment to choose from.

### Everything from order management to image correction. Can be used to drive the D703 and its system components.

#### EZ Controller (Sold separately)

The EZ Controller takes care of everything from printing to managing the orders. The graphic user interface is easy to use, even for beginners.



"Easy Operation" Order Display



PJP Display

### Solution for those who want a simple one-to-one connection

#### Operation without a RIP-PC

Installing RIP software in the controller PC eliminates the need for a separate RIP-PC.



### Solution for those who want to divide their print load among multiple printers

#### Group print function<sup>\*1</sup>

You can divide the print workload from a single order among multiple printers. This brings a reduction in print time and thereby helps to improve network efficiency.

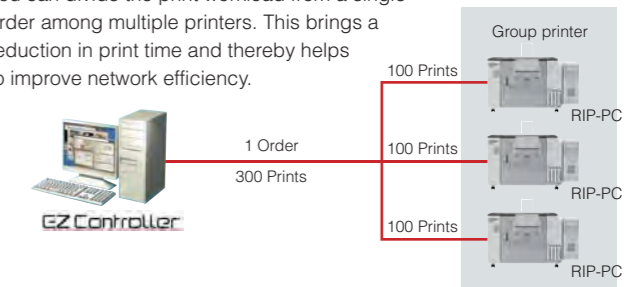

### Solution for those who have large print volumes

#### Multiple printer connection<sup>\*1</sup>

You can construct an efficient network by connecting multiple printers, mixing and matching various models including QSS minilabs (QSS-32 series and higher). Installing the newly developed EZ System Manager enables automatic distribution of the print workload among multiple printers in the network. The EZ System Manager intelligently calculates the optimal print distribution pattern, taking into account which printers are busy with other print jobs.

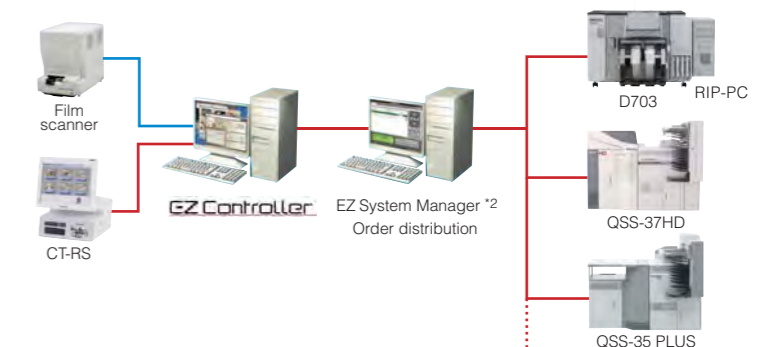

### Solution for those who have multiple operators

#### Multiple input device connection<sup>\*1</sup>

You can improve efficiency by connecting multiple computers and dividing the PJP and image correction/editing operations among these computers and perform these tasks concurrently. This is especially useful for large-volume shops as well as those offering an instant print solution.

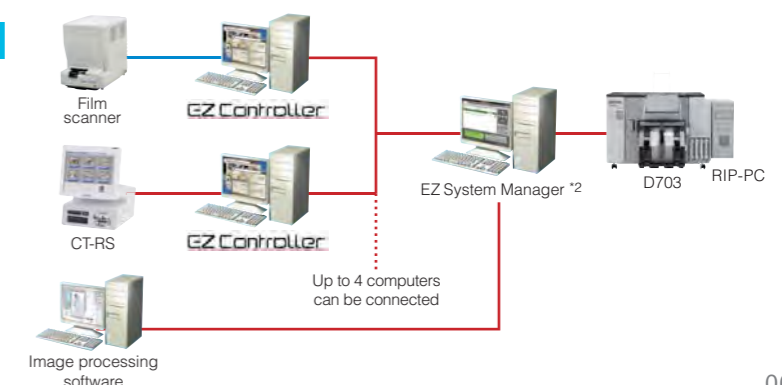

<sup>\*1</sup> A RIP-PC is required for the D703 when using an Ethernet connection and when using a multiple printer connection.

<sup>\*2</sup> EZ System Manager is scheduled to be released in summer 2009.